

The *K-TRAP*



BROCHURE
Bellows Steam Trap

The *K-TRAP*

K-Trap is a “thermostatic steam trap”, which is operated by special bellows.

K-Trap has been equipped special bellows. The bellows is expanded when saturated steam comes in to close valve, and shrunk when condensate water comes in to open valve.

K-Trap do not discharge live steam, only condensate. K-Trap is ideal long life energy saving steam trap.



The *K-TRAP*

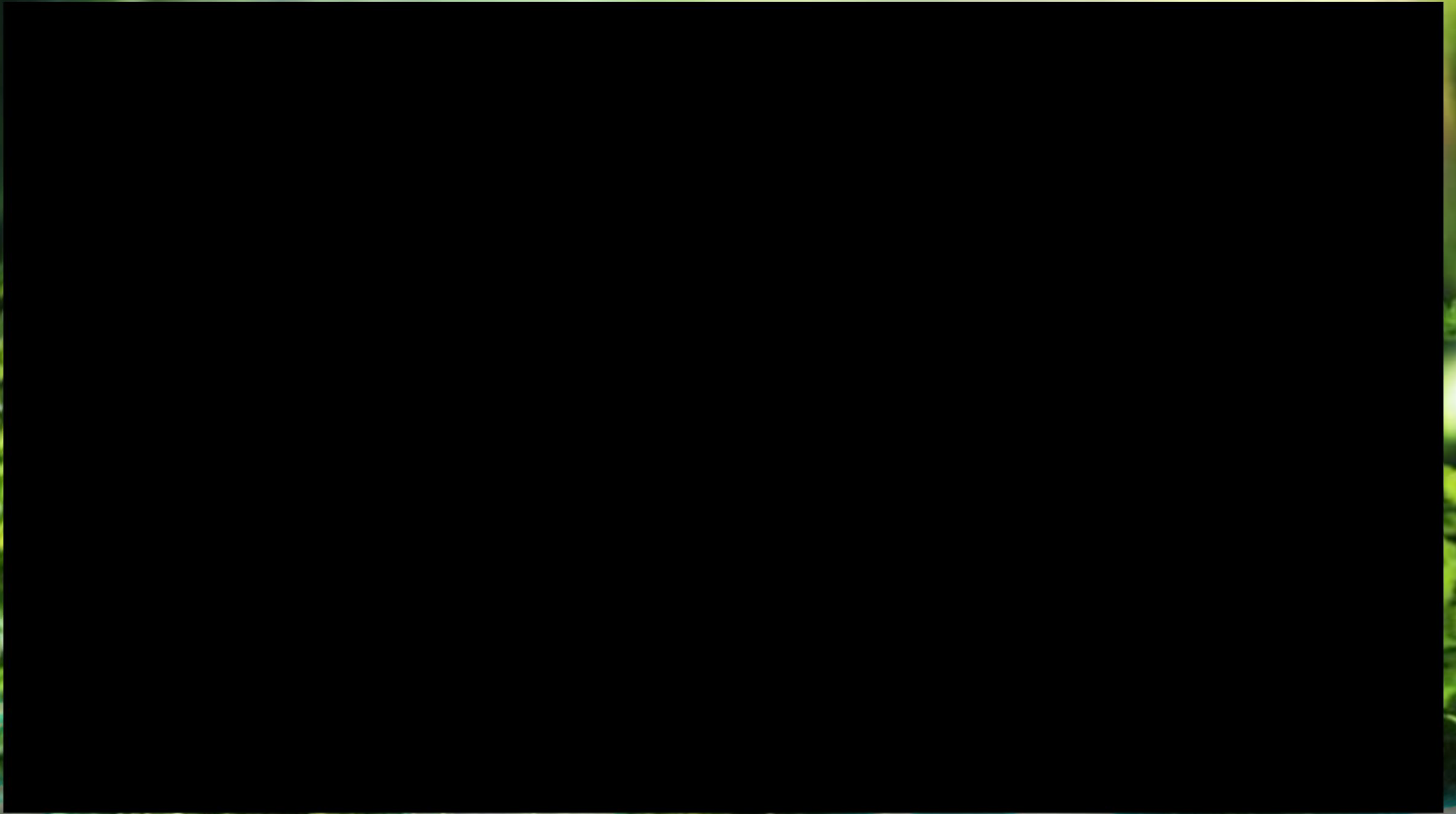

ADVANTAGE of K – TRAP



- ❖ **Excellent Water Discharge**
- ❖ **Wide Range Pressure & Temperature (0 ~ 152 bar)**
- ❖ **No Steam Leakage (Save the Energy)**
- ❖ **Easy Installation (Horizontal and Vertical Installation)**
- ❖ **No Frozen Bursting**
- ❖ **No need by-pass Valve operation for re-starting**
- ❖ **No Back Pressure, No Vibration, No Damage for Equipment and Piping Line**
- ❖ **No Corrosion, Low Noise Level**
- ❖ **Very Long Life**

ENERGY SAVING

- ✓ **CERTIFIED EMISSIONS REDUCTION**
→ 7 tCO₂ / year per 1 Steam Trap,
- ✓ **MINIMIZE STEAM LOSS**
→ SAVE 50 TON / year per 1 Steam Trap,
- ✓ **If you have 10,000 pcs steam trap in your Plant**
→ SAVE 20 mil. USD / year
→ SAVE 70,000. tCO₂ / year

THE K-TRAP - STRUCTURE

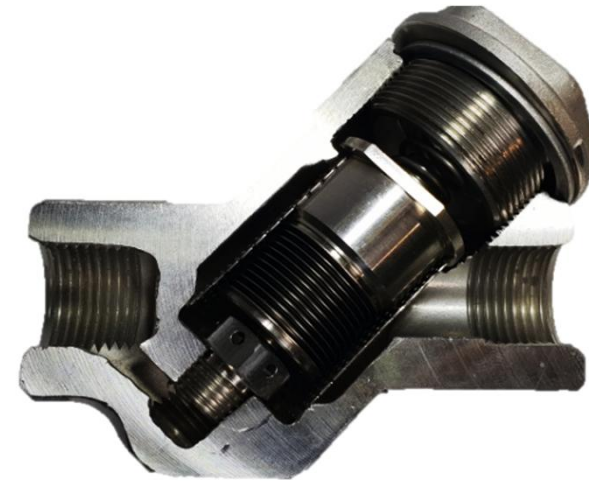
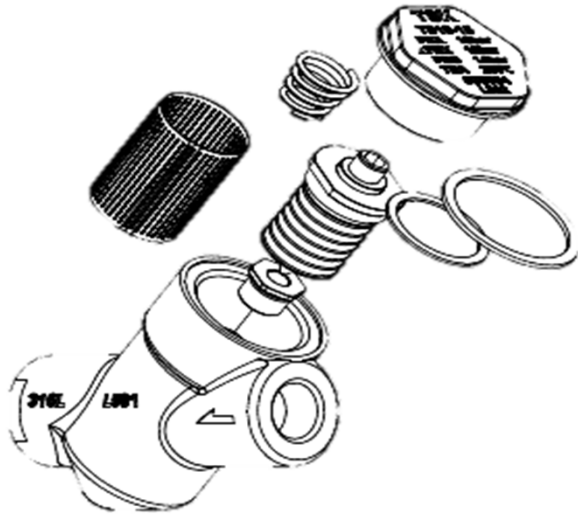

◆ MAIN PARTS

- ✓ ALL MATERIALS by SUS304
- ✓ PRECISION CASTING BODY
- ✓ BELLOWS
- ✓ BUILT-IN STRAINER

◆ ADVANTAGES

- ✓ SEMI-PERMANENT LIFETIME
- ✓ COMPACT & EFFICIENT SHAPE
- ✓ MINIMIZING STEAM LOSS
- ✓ EXCELLENT PERFORMANCE

THE K-TRAP - PRODUCT RANGE

Model		Operating Pressure	Temperature	Connection Type & Size	Material
TS-S/F 15~50A	2/304	0.3 ~ 2.0 bar	Up to 105°C	Size : ½"(15A)~2"(50A) NPT Screw End Flange End 150# ~ 600#	304 SS 316 SS
	3/304	2.1 ~ 3.0 bar	Up to 112°C		
	4.5/304	3.1 ~ 4.5 bar	Up to 121°C		
	7/304	4.6 ~ 7.0 bar	Up to 135°C		
	10/304	7.1 ~ 10.0 bar	Up to 146°C		
	14/304	10.1 ~ 14.0 bar	Up to 158°C		
	20/304	14.1 ~ 20.0 bar	Up to 170°C		
	25/304	20.1 ~ 25.0 bar	Up to 180°C		
	30/304	25.1 ~ 30.0 bar	Up to 188°C		
	40/304	30.1 ~ 40.0 bar	Up to 202°C		
	50/304	40.1 ~ 50.0 bar	Up to 212°C		
TS-F (S/P) 15~50A	Up to 152 bar, 559°C		Socket Weld End Pipe End Rating : Up to 2,500#		

THE K-TRAP - PAYTENT

◆ PAYTENT (KOREA)

CERTIFICATE OF PATENT



Patent Number 10-1060033

Application Number 10-2011-0046691

Filing Date 2011. 05. 18.

Registration Date 2011. 08. 22.

Title of the Invention
Float type steam trap

Patentee
TSK Co.,Ltd.(134811-0*****)
41, Seokpo-ro 108beon-gil, Jangam-myeon, Hwaseong-si, Gyeonggi-do

Inventor
JOO, Soon Kyu
203-613, 275, Sinjeong-ro, Yangcheon-gu, Seoul

This is to certify that, in accordance with the Patent Act, a patent for the invention has been registered at the Korean Intellectual Property Office.

2015. 04. 15.



COMMISSIONER,
KOREAN INTELLECTUAL PROPERTY OFFICE



CERTIFICATE OF UTILITY MODEL REGISTRATION



Registration Number 20-0481165

Application Number 20-2015-0006538

Filing Date 2015. 10. 05.

Registration Date 2016. 08. 17.

Title of the Device
Float type steam trap

Owner of the Utility Model Right
TSK Co.,Ltd.(134811-*****)
41, Seokpo-ro 108beon-gil, Jangam-myeon, Hwaseong-si, Gyeonggi-do

Deviser
BAIK, Chang Ki
(Yeouido-dong, Hwa-rang APT) 21, Guljegeumyung-ro 7ga-gil, Yeongdeungpo-gu, Seoul

This is to certify that, in accordance with the Utility Model Act, a utility model for the device has been registered at the Korean Intellectual Property Office.

2016. 08. 31.



COMMISSIONER,
KOREAN INTELLECTUAL PROPERTY OFFICE

최 동 규

THE K-TRAP - PAYTENT

◆ PAYTENT (USA)

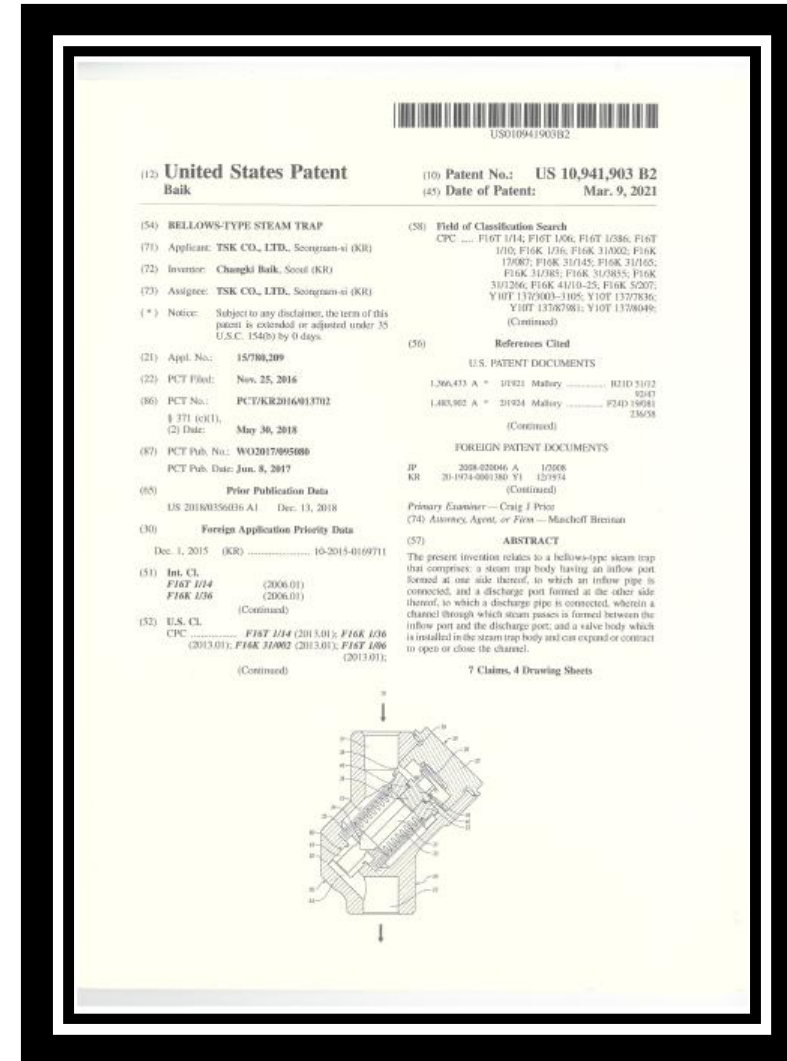
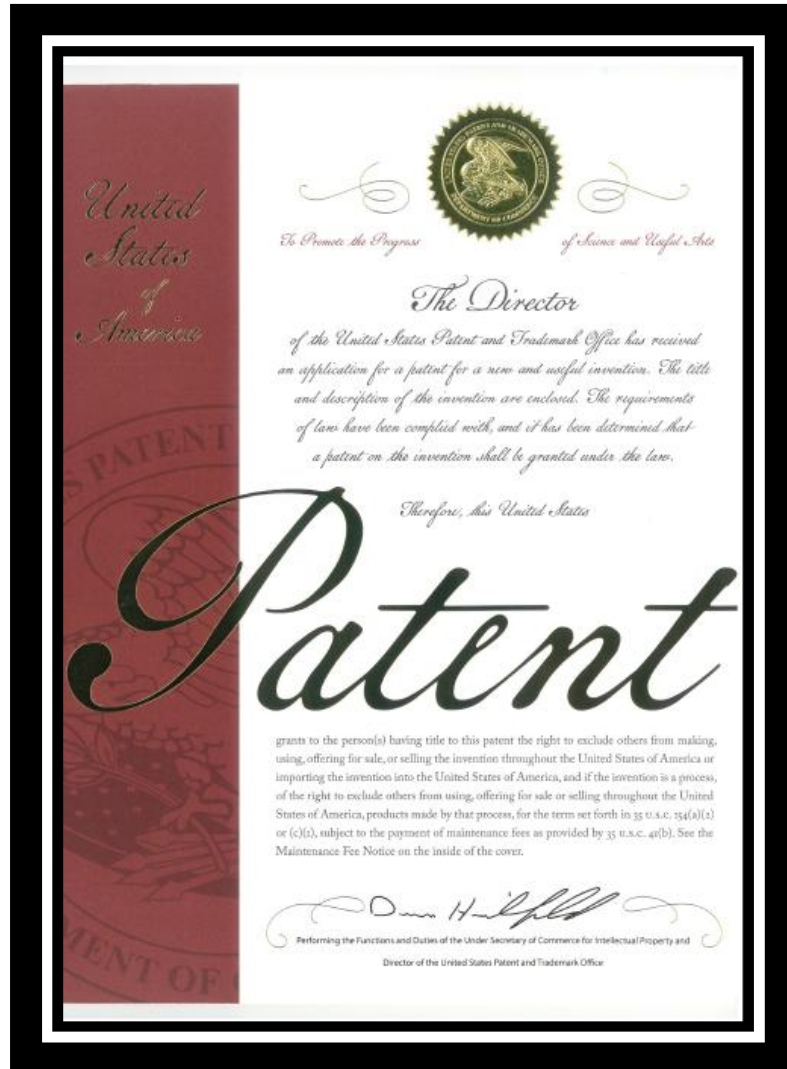

The *K-TRAP*



DISK Type Steam Trap

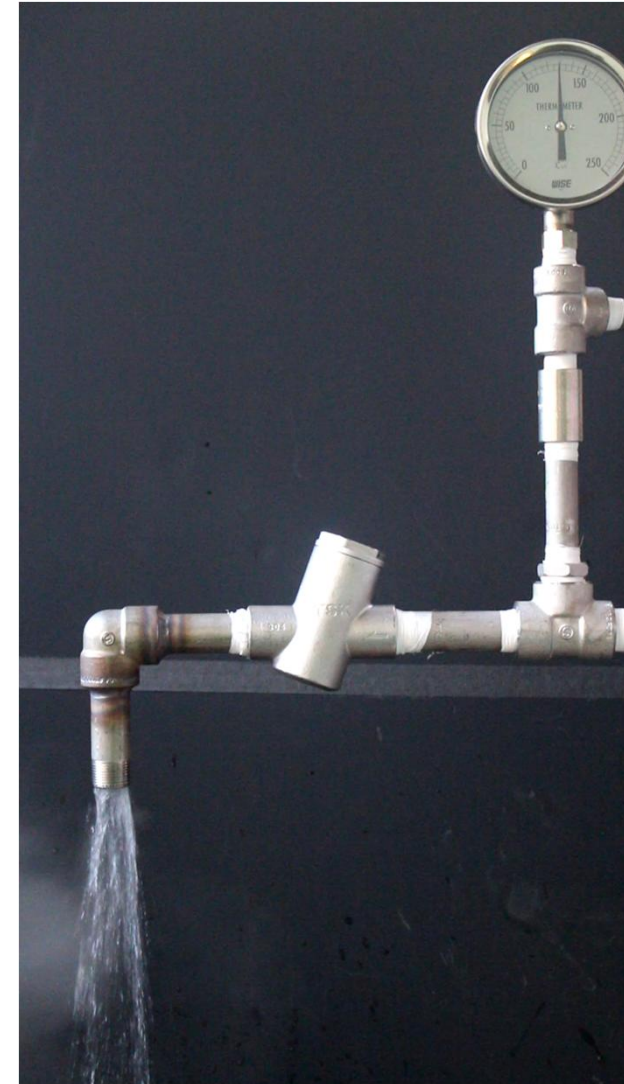

Bellows Type Steam Trap

The *K-TRAP*

Steam Trap is no more Consumable !

THANK YOU

Please contact,
Byeon Tae Gyu / Tech. Manager
tgbyeon@pscorp.co.kr, +82-10-6388-7467
<http://www.pscorp.co.kr>

PSC Corporation